

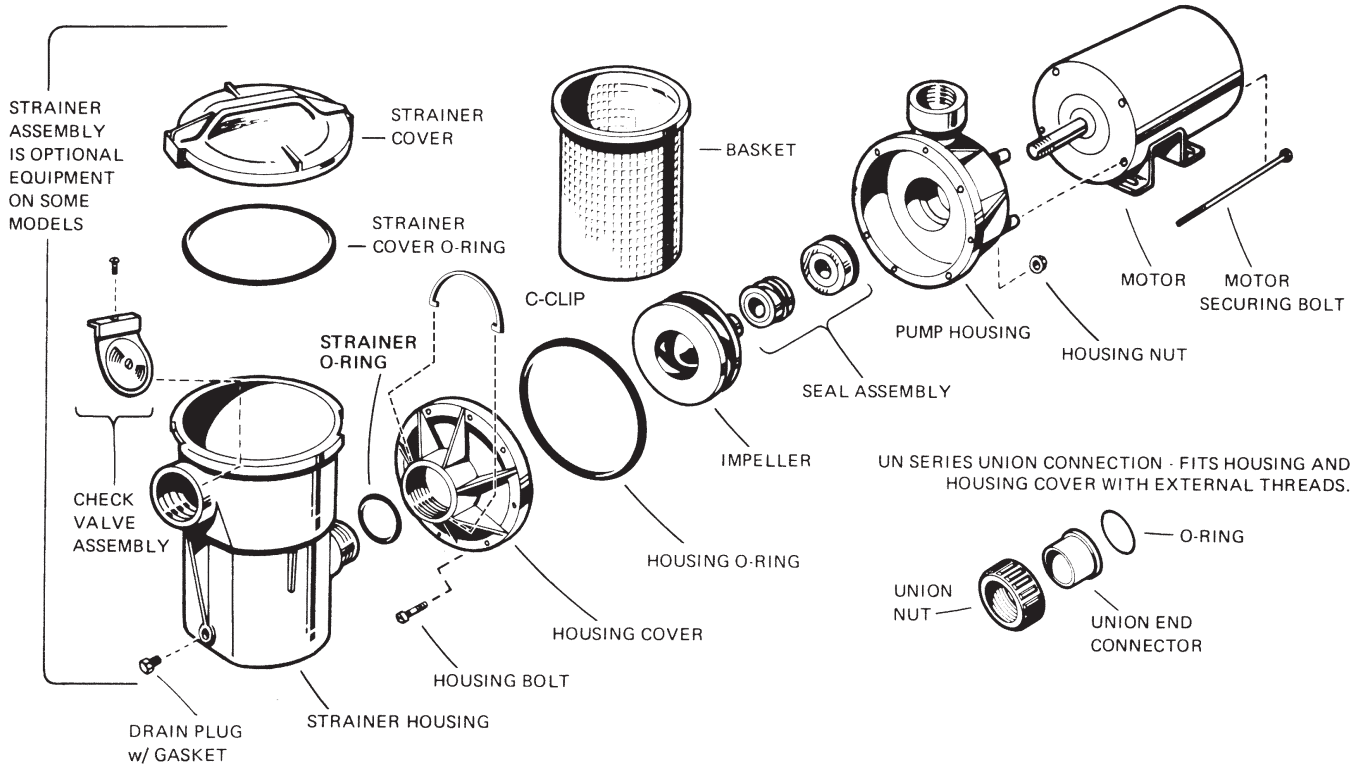

# Power-Flo II™

## SP1700 PUMP SERIES REPLACEMENT PARTS

### Parts for Pump Models: SP1705, SP1710, SP1711, SP1720, SP1725, SP1750, SP1775, SP1780



Part No.	Description	Ctn. Qty.
SPX1705AA	Pump Housing	4
SPX1705B	Housing Cover w/integral diffuser (SP1700 Series, Power-Flo II)	1
SPX1500KPA	Seal Assembly w/Cup (2003 and prior)	10
SPX1500KA	Seal Assembly	10
SPX1720KA	Seal Assembly (Power-Flo II, 1 and 1 1/2 H.P.)	10
SPX1705Z1	Housing O-Ring Gasket	10
SPX1705Z1A	Seal Assembly Housing O-Ring Gasket & Strainer O-Ring Kit	10
SPX1500N2	Housing Bolt, No. 10-24 Hex. Head	20
SPX1500Y2	Housing Nut, No. 10-24 Hex.	20
SPX1705C	Impeller, 1/2 H.P. (SP1700 Series, Power-Flo II)	10
SPX1707C	Impeller, 3/4 H.P. (SP1700 Series, Power-Flo II)	10
SPX1711C	Impeller, 1 H.P.	10
SPX2607C	Impeller (Power-Flo III, 1 H.P.)	10
SPX2610C	Impeller (Power-Flo III, 1 1/2 H.P.)	10
SPX1500CAP	Strainer Housing w/Basket	1
SPX1500D2A	Strainer Cover w/O-Ring	10
SPX1500P	Strainer Cover O-Ring	10
SPX1250RA	Strainer Basket	10
SPX1500LX	Strainer Basket – Large, 4 1/2" x 7" (1992)	10
SPX1500RA	Check Valve Assembly (1992 and prior)	10
SPX1500W	Strainer O-Ring	10
SPX1700FG	Drain Plug w/Gasket – SP1700 Series Housing	10
SPX1500X1	Shim for vertical discharge (1999 and prior)	10
SPX1515C	Strainer Housing C-Clip (2000-2003)	10
SPX1515CN	Strainer Housing C-Clip (2004- )	10

#### SP1700UN; SP1700 SD Series Parts same as SP1700 Series except as listed below:

SPX1705AAT*	Pump Housing w/External Thread (Power-Flo II, III)	4
SPX1705BD*	Housing Cover w/Contour Inlet – Self-Draining (SD)	4
SPX1500JS	Union End Connector – Socket	5
SPX1500JT	Union End Connector – Threaded	5
SPX1500G	Union Nut	10
SPX1495Z1	O-Ring, End Connector	10

\* Limited Quantity Available.